

# Additional information sheet

## FDA certification overview



**MATERIAL  
4PRINT**

your filament experts



✓ = fda approval  
✗ = no fda approval

If you have any further questions  
about the product or problems in  
its use, please contact  
[info@material4print.de](mailto:info@material4print.de)



Color	PLA	PETG	ASA	ABS	ABS-PC	PMMA	ESD-PLA
Anthrazitsilber	✓		✗	✓			
Eisengrau	✓	✗	✗	✓			
Elfenbein	✓						
Farblos	✓	✓	✗	✓	✗	✓	✗
Gelbgrün	✓						
Graualuminium	✓	✗		✓			
Grün	✓						
Himmelblau	✓	✗					
Kupfer	✓						
Leuchtgrün		✗					
Leuchthellorange		✗					
Leuchtorange	✓						
Leuchtröt	✓	✗					
Natur	✓		✗	✓	✗		
Perlblau	✓						
Perlgold	✓						
Perlviolett	✓						
Reinrot	✓	✗	✗	✓			
Signalblau	✓	✗	✗	✓			
Signalbraun	✓						
Signalweiss	✓	✗	✗	✓	✗	✓	
Staubgrau	✓	✗	✗	✓		✓	
Telemagenta	✓						
Tiefschwarz	✓	✗	✗	✓	✗	✓	
Transparent		✓					✓
Transparent Blau		✗					
Transparent Gelb		✗					
Transparent Grün		✗					
Transparent Rot		✗					
Transparent Schwarz		✗					
Verkehrsgelb	✓	✗					

These data were taken from the  
raw material manufacturer.

12.04.2021

[www.material4print.de](http://www.material4print.de)

Contact: [info@material4print.de](mailto:info@material4print.de)

# Additional information sheet

## FDA certification overview



**MATERIAL  
4PRINT**

your filament experts



✓ = fda approval  
✗ = no fda approval

If you have any further questions about the product or problems in its use, please contact [info@material4print.de](mailto:info@material4print.de)



Color	ESD-ABS	Tough PLA	PET-CF15	TPU
Anthrazitsilber				
Eisengrau				
Elfenbein				
Farblos	✗	✓	✗	
Gelbgrün				
Graualuminium				
Grün				
Himmelblau				
Kupfer				
Leuchtgrün				
Leuchthellorange				
Leuchtorange				
Leuchtrot				
Natur		✓		
Perlblau				
Perlgold				
Perlviolett				
Reinrot		✓		
Signalblau		✓		
Signalbraun				
Signalweiss		✓		
Staubgrau				
Telemagenta				
Tiefschwarz		✓		
Transparent				
Transparent Blau				
Transparent Gelb				
Transparent Grün				
Transparent Rot				
Transparent Schwarz				
Verkehrsgelb				

These data were taken from the raw material manufacturer.

12.04.2021

[www.material4print.de](http://www.material4print.de)

Contact: [info@material4print.de](mailto:info@material4print.de)

# Additional information sheet

## Spool dimensions



**MATERIAL  
4PRINT**

your filament experts

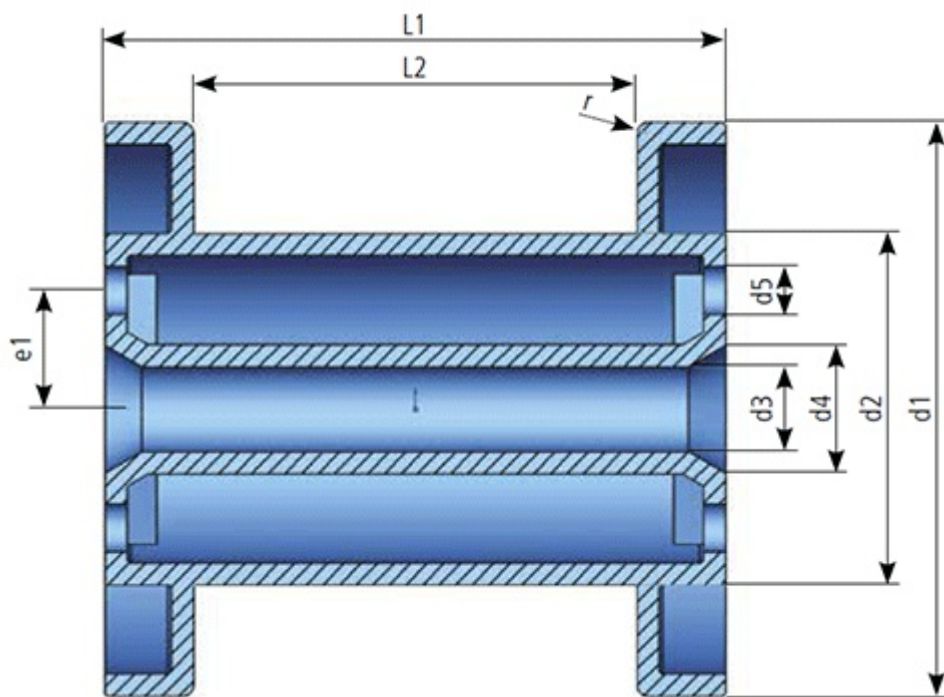

spool/ dimensions	750g	2000g	4500g	8000g
L1	55mm	100mm	105mm	170mm
d1	200mm	300mm	350mm	355mm
d3	53mm	52mm	52mm	36,5mm
weight spool	215g	615g	870g	1030g
weight including filament	>= 965g	>= 2615g	>= 5370g	>= 9030g

If you have any further questions  
about the product or problems in  
its use, please contact  
[info@material4print.de](mailto:info@material4print.de)



[www.material4print.de](http://www.material4print.de)

Contact: [info@material4print.de](mailto:info@material4print.de)